

Performance Curve for Vacuum

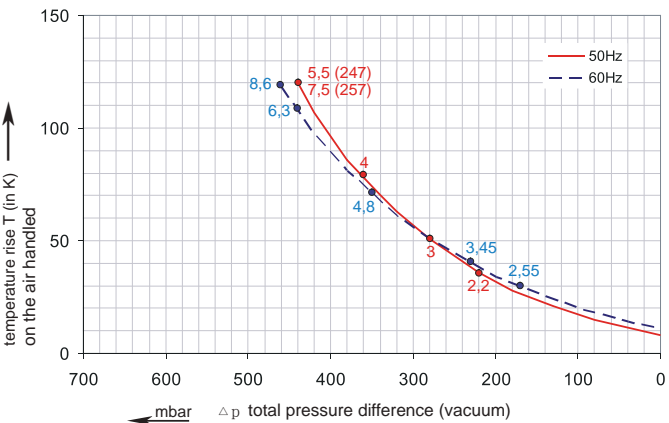

Performance Curve for Pressure

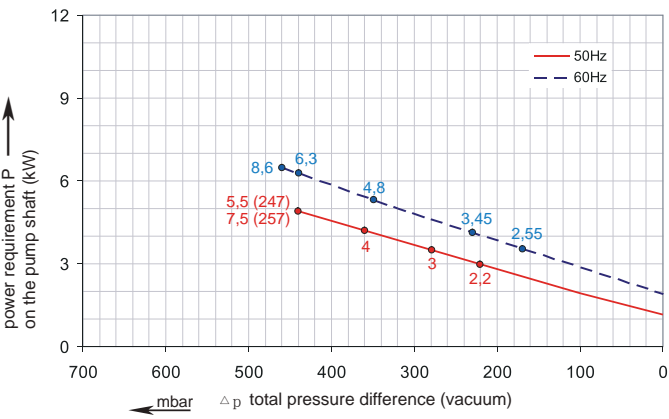
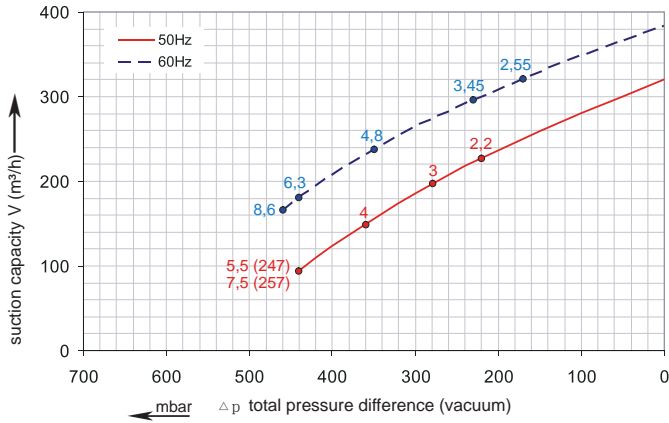
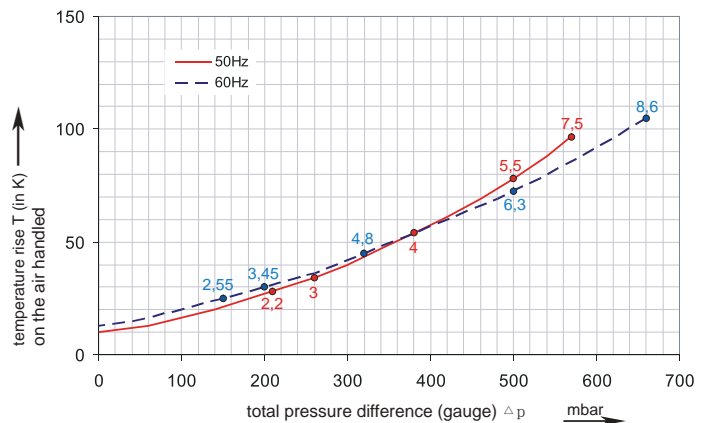
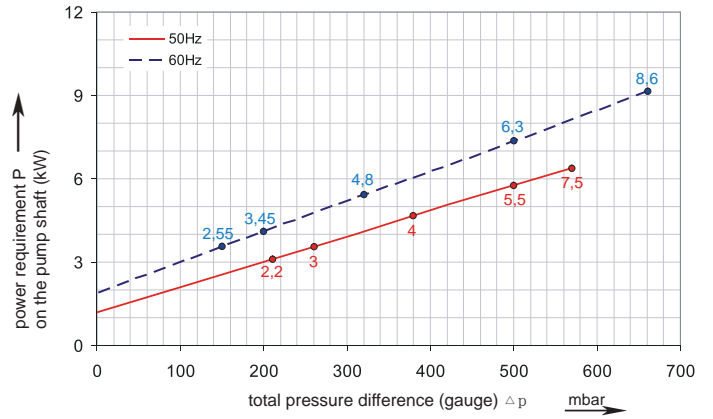
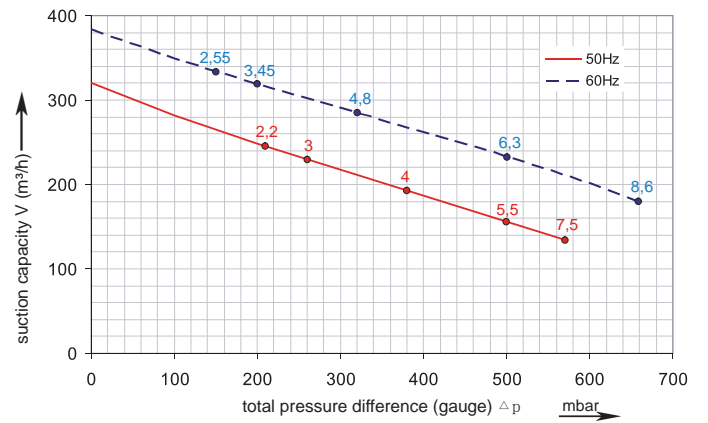

The performance curves are based on air at a temperature of 15 °C and an atmospheric pressure of 1013 mbar with a tolerance of +/- 10 %. The total pressure differences are valid for suction and ambient temperatures up to 25 °C. For other conditions please confer with us.

Each Proair Blower can be applied both as vacuum pump and compressor in continuous operation over the total stated performance curve range. The motors are available as standard for the input voltage range of 50 and 60 Hz and for protection category IP 55 as well as approved for UL and CSA.

Selection and ordering data

A-7TD

Order No.	Fre- quency	Rated power	Input voltage		Input current	Permissible total differential pressure ²⁾		Sound pressure level ³⁾	Weight ca.
			Hz	kW		V	A		

3~ 50/60 Hz IP55 isulation material class F 1)

A7TD-216	50	2.2	200D ... 240D	345Y...415Y	9.7D	5.6Y	-220	210	73	43
	60	2.55	220D ... 275D	380Y...480Y	10.3D	6.0Y	-170	150	76	43
A7TD-226	50	3.0	200D ... 240D	345Y...415Y	12.5D	7.2Y	-280	260	73	48
	60	3.45	220D ... 275D	380Y...480Y	12.6D	7.3Y	-230	200	76	48
A7TD-237	50	4.0	345D ... 415D	600Y...720Y	10.0D	5.2Y	-360	380	73	54
	60	4.8	380D ... 480D	660Y...720Y	10.4D	6.0Y	-350	320	76	54
A7TD-247	50	5.5	345D ... 415D	600Y...720Y	13.3D	7.7Y	-440	500	73	66
	60	6.3	380D ... 480D	660Y...720Y	13.3D	7.7Y	-440	500	76	66
A7TD-257	50	7.5	345D ... 415D	600Y...720Y	16.7D	9.6Y	-440	570	73	73
	60	8.6	380D ... 480D	660Y...720Y	17.3D	10.0Y	-460	660	76	73

A7TD-216, A7TD-226

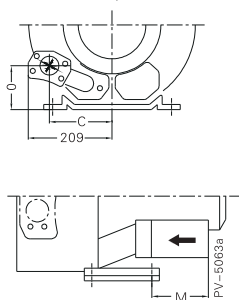

A7TD-237, A7TD-247, A7TD-257

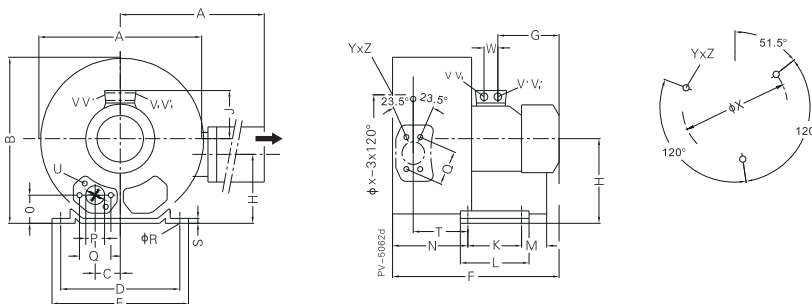

	A	A'	B	C	D	E	F	G	H	H'	J	K	L	M	N	O	φP	Q	φR	S	T	U	V	V'	V ₁	V' ₁	φX	YxZ	X-Holes	W	
A7TD-216	3~	426	426	410	63	290	325	473	191	197	162	128	140	180	84	205	53	55	83	15	4.5	130	M8x17	M25x1.5	M16x1.5	-	-	240	M10x20	51.5°/171.5°/291.5°	29
A7TD-226	3~	426	426	410	63	290	325	496	188	197	162	135	140	180	84	205	53	55	83	15	4.5	130	M8x17	M32x1.5	M32x1.5	M32x1.5	M32x1.5	240	M10x20	51.5°/171.5°/291.5°	42
A7TD-237	3~	426	426	410	63	290	325	526	209	197	162	148	140	180	84	205	53	55	83	15	4.5	130	M8x17	M32x1.5	M32x1.5	M32x1.5	M32x1.5	240	M10x20	51.5°/171.5°/291.5°	42
A7TD-247	3~	426	426	410	154	290	325	571	226	197	162	167	140	180	200	205	94	55	83	15	4.5	130	M8x17	M32x1.5	M32x1.5	M32x1.5	M32x1.5	240	M10x20	51.5°/171.5°/291.5°	42
A7TD-257	3~	426	426	410	154	290	325	571	226	197	162	167	140	180	200	205	91	55	83	15	4.5	130	M8x17	M32x1.5	M32x1.5	M32x1.5	M32x1.5	240	M10x20	51.5°/171.5°/291.5°	42



Other voltage ranges

A-7TD

50Hz

60Hz



3~

185...225 V D/320...390 V Y	200...240 V D/345...415 V Y	2	1
200...240 V D/345...415 V Y	200...275 V D/380...480 V Y	2	6
345...415 V D	380...480 V D	2	7
500 V D	575 V D	C	5

Machines according to the ATEX norm 94/4 EG are available for the whole performance range.

Following types available: Category 3 G, 3/2 G, 3 D and 3/2 D.

Further voltage range on request; please quote in plain text.

Proair Blowers achieve the standards and norms of the low voltage directive (LVD)2006/95/EC, rotating electrotechnical motor EN 60034-1-2004, electromagnetic compatibility(EMC)EN55014-1/2,EN61000-2/-3/-4/-6.

- 1) For standard UL for ELECTRIC MOTOR UL 1004-1.z
- 2) Relief-valve are available for limiting differential pressure.
- 3) Measuring-surface sound-pressure level acc. to DIN EN 21680, measured at a distance of 1 m. The pump is throttled to an average suction pressure, a hose is connected to the discharge side (compressor) / suction side (vacuum pump), but is not fitted with relief valves.

The motors are designed according to the DIN EN 60 034 / DIN IEC 34-1 and temperature class F.

For the three phase machines the tolerances are +/- 10 % for fixed voltage and +/- 5 % for voltage range.

The single phase machines are designed with a +/- 5 % tolerances. If only 90 % of the maxium allowed pressure will be used for the continuousoperating then the allowed voltage range add to +/- 10 %.

For all single and three phase machines which designed according to the UL and CSA norm (UL 1004-1) the maximum allowed voltage tolerances are - 10 % resp. + 6 %.

The frequency tolerance is maximum +/- 2 %.

Changes in particular the quoted performance curve, datas and weights without prior notice. The figures are without obligations.

03.2015